

标准定焦镜头 YN50mm F1.8Ⅸ DF DSM

使用说明书

for Z

感谢您购买Ynlens产品！

在使用本产品前, 请务必先仔细阅读本手册, 以确保您能正确、安全使用。请妥善保管好本手册, 以便日后能随时查阅。

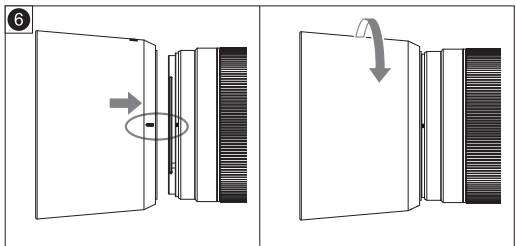
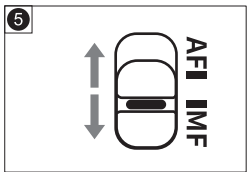
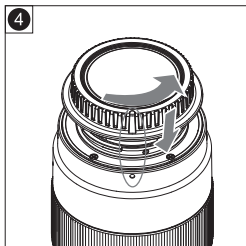
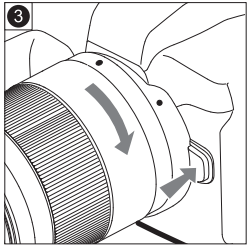
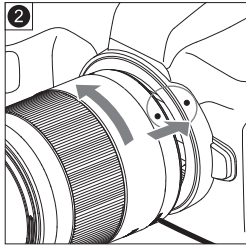
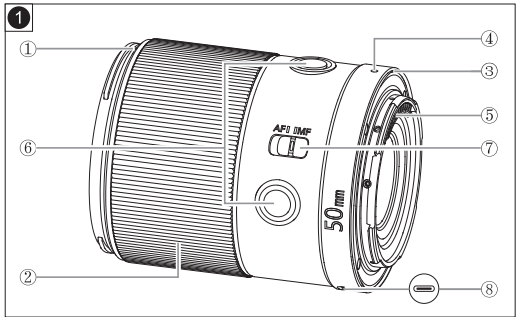

安全注意事项

- 请勿透过镜头或相机观看太阳或明亮的光源，否则会使视力受损。
- 无论镜头是否装在相机上，请勿将没有盖镜头盖的镜头置于太阳下，否则镜头可能汇聚光线并引发火灾。不使用时请盖上镜头盖。
- 请将镜头放置在儿童接触不到的地方。
- 请勿自行拆开或改造镜头。

部件说明 ①

- ①遮光罩安装标记
- ②手动对焦环/控制环
- ③橡胶圈
- ④镜头安装标记
- ⑤电子触点
- ⑥Fn多功能按钮
- ⑦对焦模式开关
- ⑧USB接口

安装与卸下镜头

详细安装及卸下镜头的步骤请参阅相机使用说明书。

安装镜头 ②

关闭相机电源，将镜头上的白色安装标志对准相机上的相同安装标志，然后以逆时针方向旋转镜头，直到听到“咔”的一声为止。

卸下镜头 ③

关闭相机电源，按下相机上的镜头释放按钮，顺时针方向转动镜头直至停止，然后卸下镜头。

- 卸下镜头后，请将镜头后端朝上放置，以避免划伤镜头表面和电子触点。如果电子触点被弄脏或沾有指纹，请用柔软的布将其擦净。
- 取下镜头后，需要装上防尘盖。请正确安装防尘盖④：将防尘盖上的安装标记对准镜头上的相同安装标记，朝逆时针方向旋转。要取下镜头盖则朝顺时针方向旋转。

对焦模式 ⑤

镜头配备对焦模式开关，支持自动对焦和手动对焦。在镜头上设置对焦模式，只需将对焦模式开关滑动到相应位置即可。相机上设置对焦模式请参阅相机说明书。

AF拍摄：将相机和镜头都设置为AF，可进行自动对焦。

MF拍摄：仅需将相机和镜头中的一个设为MF，或两者都设为MF，转动对手动对焦环进行对焦。

- 镜头未安装到相机上或相机关机时，不能调整对焦。

使用Fn多功能按钮

通过相机“L-Fn”自定义设置，可为Fn自由分配所需功能。合理分配Fn按钮可快速调出某一功能菜单或执行某一快捷操作，以减少翻找相机菜单的时间，提高创作效率。更多详细操作请参考相机说明书。

控制环

在**自动对焦**模式中，旋转控制环可执行相机预先选择的功能。根据需求可将常用功能分配到控制环上，如光圈、ISO、曝光补偿等，完成设置后转动控制环即可更改相应参数设置。更多详细操作请参阅相机说明书。

遮光罩 ⑥

安装遮光罩可以保护镜头和阻挡可能导致杂光或鬼影的散射光线。

安装：将遮光罩上的安装标记与镜头前端的安装标记对齐，然后顺时针转动遮光罩直至停止。

拆卸：逆时针旋转遮光罩直至停止，然后取下遮光罩。

- 遮光罩可反向安装以便存放。
- 遮光罩安装不当，可能会遮挡部分图像。
- 使用内置闪光灯或使用相机上安装的外部闪光灯时，建议取下遮光罩，以免挡住闪光灯光线。

滤光镜（需另购）

可在镜头前端的螺纹上安装一个直径58mm的滤光镜。

- 每次只能安装一个滤光镜。

固件升级

本产品支持固件升级，您可以登录网址 <https://www.hkyongnuo.com/xzyzc> 下载最新升级软件和最新固件。使用前，

建议升级到最新固件以获取最佳使用体验。

升级方法为：关闭相机电源，将镜头从相机上取下，通过USB Type-C线（需另购）与电脑连接，打开升级软件并按照软件提示完成升级操作。

保养及存放注意事项

- 应避免撞击或直接放置在酷热、极冷或潮湿的环境下。
- 如果长期存放，请选择阴凉干爽及通风良好的地方。建议远离防虫丸或防虫丸发出气体的地方，以保护镜头的镀膜层。
- 镜片上的污垢或者指纹可用柔软微湿的镜头布或镜头纸清洁，切勿使用溶剂、苯或其他有机清洁剂。
- 温度突变可能会令镜头表面凝结雾气或水珠，因此在天气寒冷时进入暖和的室内环境，最好将镜头放在密封的塑胶袋内，直至镜头温度接近室温为止。将镜头从温暖的环境拿到寒冷的环境中时，也请使用同样的方法。

故障排除

1.手动对焦时已经调至最清晰，但成像依然是模糊的

请检查镜头两端镜片是否存在指纹或污垢，如果存在请使用柔软微湿的镜头布或擦镜纸擦拭干净。

2.无法自动对焦

进行AF拍摄时，请确保相机和镜头的对焦模式均已设为AF。

3.镜头装相机上通信异常

请确保镜头安装到位；请检查镜头触点和相机触点是否被弄脏或划伤，如果被弄脏请用柔软的布将其擦净，如果被划伤请返厂维修。

4.Fn功能按钮无法工作

检查相机是否分配了指定功能。

5.控制环无法工作

检查相机是否已分配指定功能。确保相机和镜头均已设为AF状态。

6.其他异常情况

请尝试关闭相机电源并取出相机电池，然后装回电池再重启电源试试。如果仍有异常，请致电永诺售后服务中心400-001-3888或发送邮件至service@hkyongnuo.com进行咨询。

规格

镜头焦距		50mm
视角范围	对角线	47.82°
	垂直	27.63°
	水平	40.23°
卡口	Z卡口	
画幅	全画幅	
镜头结构	8组11片	
光圈叶片	9	
最小光圈	F/16	
最近对焦距离	0.45m	
最大放大倍率	0.15×	
驱动系统	数控步进电机	
滤光镜直径	58mm	
最大直径及长度	约φ68×87mm	
重量	约 417g	

■ 镜头长度是指从安装面到镜头前端的距离。

■ 除特别说明外，尺寸和重量只适用于镜头。

■ 光圈设置可以由相机指定。

本说明书最新电子版可在永诺官方网站<https://www.hkyongnuo.com/xzyzc>获取。

本使用说明书中的功能及数据均是依据本公司的测试条件获得。设计和规格如有变更，恕不另行通知。

制造商：深圳市永诺电器有限公司
地址：深圳市龙岗区宝龙街道同乐社区园新路13号稳好工业厂区301
电话：（86）0755-33001023
销售商：深圳市永诺摄影器材股份有限公司
地址：深圳市坪山区坑梓街道深福保现代光学厂区A座
电话：（86）0755-83762448 传真：（86）0755-83762765
网址：www.hkyongnuo.com 售后电话：400-001-3888

STANDARD PRIME LENS
YN50mm F1.8ⅳ DF DSM

USER MANUAL

for Z

Thank you for purchasing Yn|ens product!

Before using the product, please read the instruction manual carefully to ensure that you use the product properly. Please keep the manual properly for future reference.

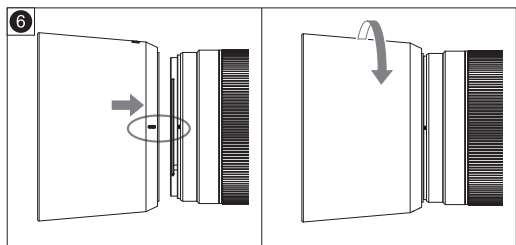
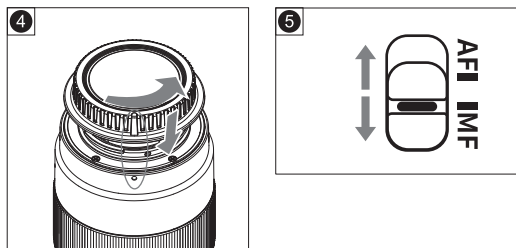
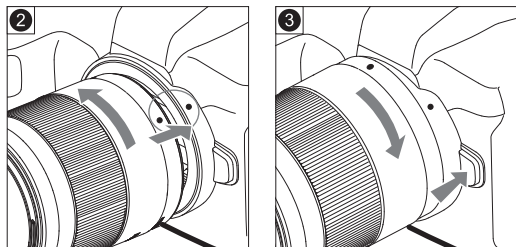
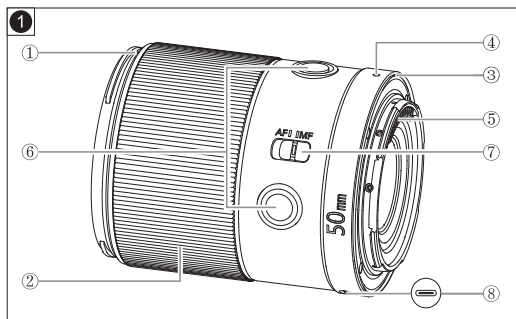

Safety precautions

- * Do not look at the sun or other bright light sources through the lens or camera, otherwise it may damage your eyesight.
- * Regardless of whether the lens is attached to the camera or not, do not leave the lens under the sun without a lens cap, as the lens may condense light and cause a fire. Please put on the lens cap when the lens is not in use.
- * Keep the lens out of reach of children.
- * Do not disassemble or modify the lens by yourself.

Parts description ①

- ① Lens hood installation mark
- ② Manual focus ring/control ring
- ③ Rubber ring
- ④ Lens installation mark
- ⑤ Electronic contacts
- ⑥ Fn multi-function button
- ⑦ Focus mode switch
- ⑧ USB interface

Mounting and removing the lens

Please refer to the camera's instruction manual for detailed steps of mounting and removing the lens.

Mounting the lens ②

Turn off the camera. Align the white mounting mark on the lens with the same mounting mark on the camera, and then rotate the lens counterclockwise until you hear a "click".

Removing the lens ③

Turn off the camera. Press the lens release button on the camera, turn the lens clockwise until it stops, and then remove the lens.

- * After removing the lens, place the bottom of the lens facing up to avoid scratching the lens surface and electrical contacts. If the electrical contacts are dirty or stained with fingerprints, please wipe them clean with a soft cloth.
- * After removing the lens, attach the dust cap. Please install the dust cover correctly ④: align the mounting mark on the dust cover with the same mounting mark on the lens and rotate it counterclockwise. To remove the lens cap, turn it clockwise.

Focus mode ⑤

The lens is equipped with a focus mode switch, which supports auto focus and manual focus. To set the focus mode on the lens, just slide the focus mode switch to the corresponding position. Please refer to the camera manual for setting the focus mode on the camera.

AF shooting: please set the focus mode of the camera and lens to AF for autofocus.

MF shooting: Set the mode to MF on either the camera or the lens, or both, and turn the manual focus ring to focus.

- * The focus cannot be adjusted when the lens is not attached to the camera or the camera is turned off.

Fn multi-function button

Through the camera's "L-Fn" custom settings, you can freely set the required functions for the Fn multi-function button.

Reasonable setting of the Fn multi-function button can quickly call up a certain function menu or perform a certain shortcut operation, which saves time of checking the camera menu, and improves the creative efficiency.

Fn custom function setting requires to be supported by camera, please refer to the camera manual for details.

Control ring

In autofocus mode, you can rotate this control ring to perform a function selected with the camera. You can assign the common functions such as aperture, ISO, Exposure compensation, etc. to the control ring according to your needs. After finishing the settings, rotating the control ring can adjust the corresponding parameters. For more details, please refer to the camera manual.

Lens hood ⑥

Installing the lens hood can protect the lens and block the scattering light which causes parasitic light and ghosting.

Installation: Align the installation mark on the lens hood with that of on the front of the lens, then turn the lens hood clockwise until it stops.

Remove: Turn the lens hood counterclockwise until it stops, and take off the lens hood.

- * The lens hood can be installed reversely for storage.
- * Improper installation of the lens hood may block part of the image.
- * Please take off the lens hood to avoid blocking the light of the flash when using built-in flash or external flash mounted on the camera.

Filter (needs to be purchased separately)

A 58mm diameter filter can be installed on the screw thread of the front of the lens.

- * Only one filter can be installed at a time.

Firmware upgrade

This product supports firmware upgrade. Users can log in to the YONGNUO official website: <https://www.hkyongnuo.com/xzyzc> to download the latest upgrade software and firmware. Please upgrade to the latest firmware for the best use experience before using.

The upgrade method: Turn off the camera, take off the lens from the camera. Connect it to the computer via a USB Type-C cable (needs to be purchased separately). Open the upgrade software and follow the software prompts to upgrade.

Precautions for maintenance and storage

- * Avoid collision or being placed directly in extremely hot, cold or humid environment.
- * Please choose a cool, dry and well-ventilated place for long-term storage. It is recommended to stay away from Moth Proof Balls or areas where the gas is emitted to protect the coating layer of the lens.
- * Dirt or fingerprints on lenses can be cleaned with soft and slightly wet lens cloth or lens paper. Do not use solvent, benzene or other organic cleaners
- * A sudden change in temperature may cause fog or water droplets to condense on the surface of the lens. Therefore, when entering a warm indoor environment in cold weather, Please place the lens in a sealed plastic bag until the lens temperature is closed to room temperature. Please use the same method when taking the lens from a warm environment to a cold environment.

Troubleshooting

1.The manual focus has been set to maximum sharpness, but the image is still blurry

Please check if there are any fingerprints or dirt at both ends of the lens. If so, clean them with a soft and damp lens cloth or lens wipe paper.

2.Unable to auto focus

When shooting in AF mode, please make sure the focus modes of the camera and lens are both set to AF

3.The communication is abnormal when mounting the lens on the camera

Please make sure the lens is properly installed; Please check whether the contacts of lens and camera are stained or scratched. If they are soiled, please wipe them with a soft cloth. If they are scratched, please return the product to the factory for repair.

4.The function button Fn does not work

Please check whether the camera is assigned the specified function.

5.The control ring does not work

Please check whether the camera has been assigned the specified function. Make sure the camera and lens are set to AF.

6.Other abnormal conditions

Please try to power off the camera and take out the battery, and then reinstall the battery and power on. If it is still abnormal, please call the YONGNUO After Sales Center at 400-001-3888 or send an email to service@hkyongnuo.com for advice.

Specification

Focal Length	50mm	
Angle of view	Diagonal	47.82°
	Vertical	27.63°
	Horizontal	40.23°
Lens Mount	Z Mount	
Lens Frame	Full Frame	
Lens Construction	11 elements in 8 groups	
Aperture Blades	9	
Minimum Aperture	F/16	
Minimum Focusing Distance	0.45m	
Maximum Magnification	0.15×	
Driving System	Digital stepper motor	
Filter Diameter	58mm	
Max. Diameter × Length	Aboutφ68×87mm	
Weight	About 417g	

- The lens length refers to the distance from the mounting side to the lens front end.
- Unless special stated, the dimension and weight is only suitable for lens.
- The Aperture can be specified by the camera.

The electronic edition of this user manual can be acquired from <https://www.hkyongnuo.com/xzyzc>.

The function and data listed in this manual are acquired according to YONGNUO testing conditions. The design and specification are subject to change without notice.