

标准定焦镜头
YN50mm F1.8X DA DSM Pro

使用说明书

for X

感谢您购买本产品！

在使用本产品前，请务必先仔细阅读本手册，以确保您能正确、安全使用。请妥善保管好本手册，以便日后能随时查阅。

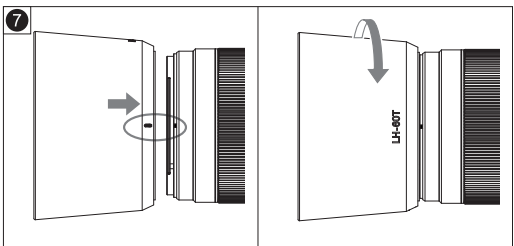
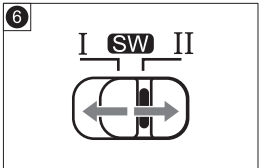
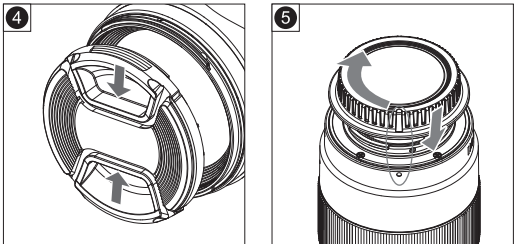
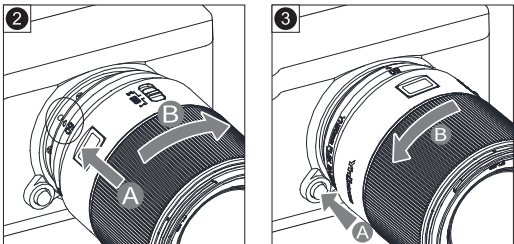
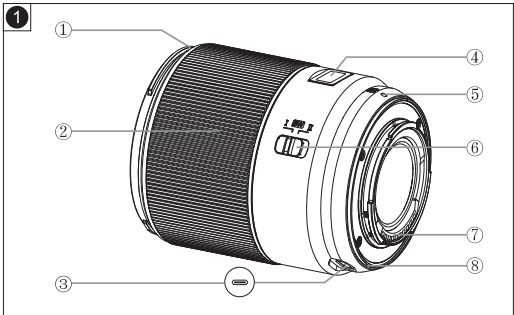

安全注意事项

- 请勿透过镜头或相机观看太阳或明亮的光源，否则会使视力受损。
- 无论镜头是否装在相机上，请勿将没有盖镜头盖的镜头置于太阳下，否则镜头可能汇聚光线并引发火灾。不使用时请盖上镜头盖。
- 请将镜头放置在儿童接触不到的地方。
- 请勿自行拆开或改造镜头。

部件说明 ①

- ①遮光罩安装标记
- ②对焦环/光圈环
- ③USB接口
- ④显示屏
- ⑤镜头安装标记
- ⑥功能开关
- ⑦电子触点
- ⑧镜头卡口橡胶圈

安装与卸下镜头

详细安装及卸下镜头的步骤请参阅相机使用说明书。

安装镜头 ②

将镜头上的红色安装标志对准相机上的相同安装标记（A），然后以顺时针方向旋转镜头（B），直到听到“咔”的一声为止。

卸下镜头 ③

按下相机上的镜头释放按钮（A），并同时逆时针方向转动镜头直至停止（B），然后卸下镜头。

- * 卸下镜头后，请将镜头后端朝上放置，以避免划伤镜头表面和电子触点。如果电子触点被弄脏或沾有指纹，请用柔软的布将其擦净。
- * 取下镜头时，需要装上防尘盖。请正确安装防尘盖⑥：将防尘盖上的安装标记对准镜头上的相同安装标记，朝顺时针方向旋转。要取下镜头盖则朝逆时针方向旋转。

对焦环/光圈环 ⑥

1.作为对焦环使用：将功能开关设为“II”。

a.自动对焦（AF）：在相机上将对焦模式设置为AF，然后半按快门进行对焦。

相机设为AF-S，并开启[AF+MF]功能，在半按快门完成自动对焦后可以通过转动对焦环进行手动对焦。详细信息请参阅相机的说明书。

b.手动对焦（MF）：在相机上将对焦模式开关设为MF，并转动对焦环进行对焦。

* 镜头未安装到相机上或相机关机时，不能调整对焦。

2.作为光圈环使用：将功能开关设为“I”。

a.转动光圈环，直至镜头液晶屏显示“AUTO”，此时镜头光圈值将受控于相机。

b.转动光圈环，直至镜头液晶屏显示具体光圈值，此时光圈将由镜头控制环控制。

遮光罩 ⑦

安装遮光罩可以保护镜头和阻挡可能导致杂光或鬼影的散射光线。

安装：将遮光罩上的安装标记与镜头前端的安装标记对齐，然后顺时针转动遮光罩直至停止。

拆卸：逆时针旋转遮光罩直至停止，然后取下遮光罩。

- * 遮光罩可反向安装以便存放。
- * 遮光罩安装不当，可能会遮挡部分图像。
- * 使用内置闪光灯或使用相机上安装的外部闪光灯时，建议取下遮光罩，以免挡住闪光灯光线。

滤光镜（需另购）

可在镜头前端的螺纹上安装一个直径58mm的滤光镜。

* 每次只能安装一个滤光镜。

固件升级

本产品支持固件升级，您可以登录官网<https://www.hkyongnuo.com/xzyzc>下载最新固件。使用前，建议升级到最新固件以获取最佳使用体验。如需了解更详细的操作步骤，请参阅固件更新操作指南。

保养及存放注意事项

- 应避免撞击或直接放置在酷热、极冷或潮湿的环境下。
- 如果长期存放，请选择阴凉干爽及通风良好的地方。建议远离防虫丸或防虫丸发出气体的地方，以保护镜头的镀膜层。
- 镜片上的污垢或者指纹可用柔软微湿的镜头布或镜头纸清洁，切勿使用溶剂、苯或其他有机清洁剂。
- 本镜头并不完全防水，下雨或者接近水源使用时须特别小心，切勿弄湿。倘若内部机件、镜片及电子零件因弄湿受损，很可能无法维修。
- 温度突变可能会令镜头表面凝结雾气或水珠，因此在天气寒冷时进入暖和的室内环境，最好将镜头放在密封的塑胶袋内，直至镜头温度接近室温为止。将镜头从温暖的环境拿到寒冷的环境中时，也请使用同样的方法。

故障排除

1.手动对焦时已经调至最清晰，但成像依然是模糊的

请检查镜头两端镜片是否存在指纹或污垢，如果存在请使用柔软微湿的镜头布或擦镜纸擦拭干净。

2.镜头装相机上通信异常

请确保镜头安装到位；请检查镜头触点和相机触点是否被弄脏或划伤，如果被弄脏请用柔软的布将其擦净，如果被划伤请返厂维修。

3.其他异常情况

请尝试关闭相机电源并取出相机电池，然后装回电池再重启电源试试。

规格

镜头焦距		50mm
视角范围	对角线	32.43°
	垂直	18.46°
	水平	27°
画幅		APS-C
镜头结构		8组11片
光圈叶片		9
最小光圈		F/16
最近对焦距离		0.45m
最大放大倍率		0.15×
驱动系统		数步步进马达
滤光镜直径		58mm
最大直径及长度		约φ68×85mm
重量		约 387g

■ 镜头长度是指从安装面到镜头前端的距离。

■ 除特别说明外，尺寸和重量只适用于镜头。

■ 光圈设置可以由相机指定。

本说明书最新电子版登录网站<https://www.hkyongnuo.com/xzyzc>获取。

本使用说明书中的功能及数据均是依据本公司的测试条件获得。设计和规格如有变更，恕不另行通知。

STANDARD PRIME LENS
YN50mm F1.8X DA DSM Pro

USER MANUAL
for X

Thank you for purchasing YONGNUO product!
Before using the product, please read the instruction manual carefully to ensure that you use the product properly. Please keep the manual properly for future reference.

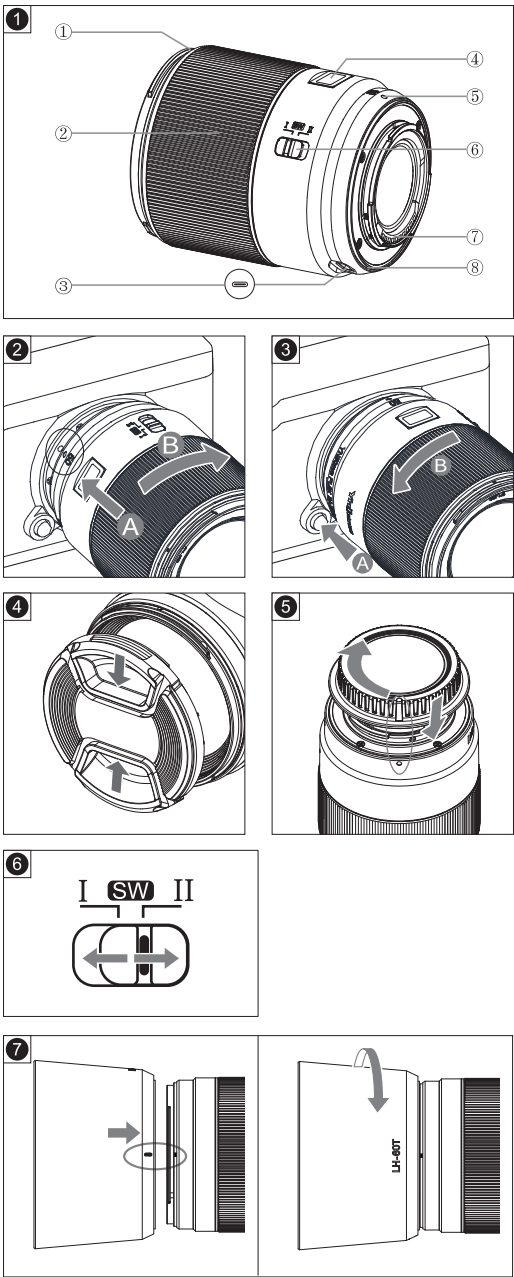

Safety Precautions

- Please do not look at the sun or bright light source through the lens or camera,otherwise it might cause visual impairment.
- Whether the lens is mounted on the camera or not,please do not place the lens under the sun without lens cap covered,otherwise the lens might gather light and cause a fire.Please cover the lens with lens cap when not in use.
- Please keep the lens out of reach from children.
- Please do not disassemble or modify this product.

Nomenclature ❶

- ❶Lens hood mounting mark
- ❷Focus ring/Aperture ring
- ❸USB interface
- ❹LCD monitor
- ❺Lens mounting mark
- ❻Function switch
- ❼Electronic contact
- ❽Lens mount rubber ring

Mounting and Detaching the Lens

For details on mounting and detaching the lens,please refer to your camera's user manual.

Mounting the Lens ❷

Please align the mounting mark on the lens with the same mounting mark on the camera(❶),then rotate the lens clockwise until 'click' is heard(❸).

Detaching the Lens ❸

Press the lens release button on the camera(❶),and rotate the lens anticlockwise until stop,then detach the lens(❸).

- After detaching the lens,please place the lens with the rear end up to prevent lens and electronic contact from getting scratched. If the electronic contact get dirty or contaminated with fingerprints,please clean them with soft cloth.
- When detaching the lens,please cover it with dust cap.Please mount the dust cap properly❹,align the mounting mark on the dust cap with the same mounting mark on the lens,then rotate clockwise.If you need to detach the lens cap,rotate it anticlockwise.

Focus Ring/Aperture ring ❹

1. Use as a focus ring: Set the function switch to 'II' .

a. Autofocus (AF): Set the focus mode to AF on the camera, and then half-press the shutter button to focus.
When the [AF+MF] menu option is set to 'on', half-press the shutter button to complete the focus and then you can focus by rotating the focus ring. For details, refer to the camera's manual.

b.Manual Focus (MF): Set the focus mode to MF on the camera and adjust the focus by turning the focus ring.
• Focus cannot be adjusted when the lens is not attached to the camera or when the camera is turned off.

2. Use as an aperture ring: Set the function switch to 'I'.

- a.** Rotate the aperture ring until the lens LCD displays 'AUTO', at which point the lens aperture value will be controlled by the camera.
- b.** Rotate the aperture ring until the lens LCD displays other specific aperture values, aperturewill be controlled by the lens aperture ring.

Lens Hood ❺

Mounting lens hood can protect lens and block scattered rays which might cause stray light or ghosting.

Mounting: Align the mounting mark on the lens hood with the mounting mark on the front lens,then rotate the lens hood clockwise until stop.

Detaching: Rotate the lens hood anticlockwise until stop,then take down the hood.

- The hood can be reverse-mounted on the lens for storage.
- If the lens hood is mounted improperly,part of the picture may be blocked.
- When using built-in-flash or on-camera flash,it is suggested to take out the hood so as not to block the flash light.

Filters(Sold Separately)

You can attach a filter in 58mm diameter to the filter mounting thread on the front of the lens.

- Only one filter can be attached each time.

Firmware Upgrade

This product supports firmware upgrade, you can log in to the website <https://www.hkyongnuo.com/xzyzc> to download the latest firmware. Before use,we suggest you upgrade the lens to

the latest firmware for the best user experience. For more detailed steps, see the firmware update how-to guide.

Maintenance and Storage Precautions

- Please avoid collision or placing the lens directly in extremely hot,cold and humid environment.
- For long storage,please choose a cool,dry and well-ventilated place.Please keep away from pest control pills or places where the pest control pills give off gas,to protect the lens coating.
- For cleaning the dirt or fingerprint,you can use soft and slightly wet lens cleaning cloth or lens paper,please do not use solvents, benzene or other organic cleaners.
- This lens is not water-proof,please be careful when it rains or being placed near water source,please do not get it wet;if the inner parts,lens or electronic parts get damaged by damp,it may be unable to repair.
- Temperature jump may result in condensation of mist and water-beads,therefore,when you get in a warm indoor environment in cold weather,you had better put the lens in sealed plastic bag to wait until the lens temperature is close to room temperature.Please do the same when the lens is taken from warm to cold environment.

Troubleshooting

1.In manual focus,the image quality is adjusted to the clearest,but the image is still blurry

Please check if there are fingerprints or dirt on the front and rear lens,if so,please use soft and slightly wet lens cloth or lens paper to wipe up.

2.Communication Error When Lens is Mounted on Camera

Please make sure the lens is mounted properly;Please check if the lens contacts and camera contacts are soiled or scratched;if it is soiled,please use soft cloth to wipe up;if it is scratched,please return for repair.

3.Other Problems

Please try turning off the camera and taking out the camera battery,then put back the battery,try rebooting the camera.

Specification

Focal Length		50mm
Angle of view	Diagonal	32.43°
	Vertical	18.46°
	Horizontal	27°
Lens Frame		APS-C
Lens Construction		11 elements in 8 groups
Aperture Blades		9
Minimum Aperture		F/16
Minimum Focusing Distance		0.45m
Maximum Magnification		0.15x
Driving System		Digital stepper motor
Filter Diameter		58mm
Max. Diameter × Length		Aboutφ68×85mm
Weight		About 387g

- The lens length refers to the distance from the mounting side to the lens front end.
- Unless special stated,the dimension and weight is only suitable for lens.
- The Aperture can be specified by the camera.

The electronic edition of this user manual can be acquired from <https://www.hkyongnuo.com/xzyzc>.

The function and data listed in this manual are acquired according to Yongnuo testing conditions.The design and specification are subject to change without notice.

Shenzhen YONGNUO Electronic Equipment Co., Ltd.
Add:Room 209 Building A1&F/2-5, Building A2, Block A, No.14 Jinxiu East Road, Xiuxin Community, Kengzi Street, Pingshan District, Shenzhen
Tel:(86)0755-33001023 E-mail:service@hkyongnuo.com
Service Tel:400-001-3888 Web:www.hkyongnuo.com